

Digital Inspection Camera

MAXIVIDEO MV105S/108S

PRODUCT INTRODUCTION

The MV105S/108S digital inspection camera is designed to work with Autel diagnostic tablets. It turns your Autel tablet into a video inspection scope, allowing you to examine difficult-to-reach areas normally hidden from sight. It is capable of recording digital still images and videos, which offers you an economical solution to inspect machinery, facilities, and infrastructure in a safe and quick way.

1. Imager Head Cable — used for viewing image and video.
2. Handgrip — ergonomically designed handle for comfortable grips and agile operation.
3. USB Cable — connects the Digital Inspection Camera to the Autel tablet.

NOTE: The power of the MaxiVideo tool is directly supplied by the USB port, and no external power source is needed.

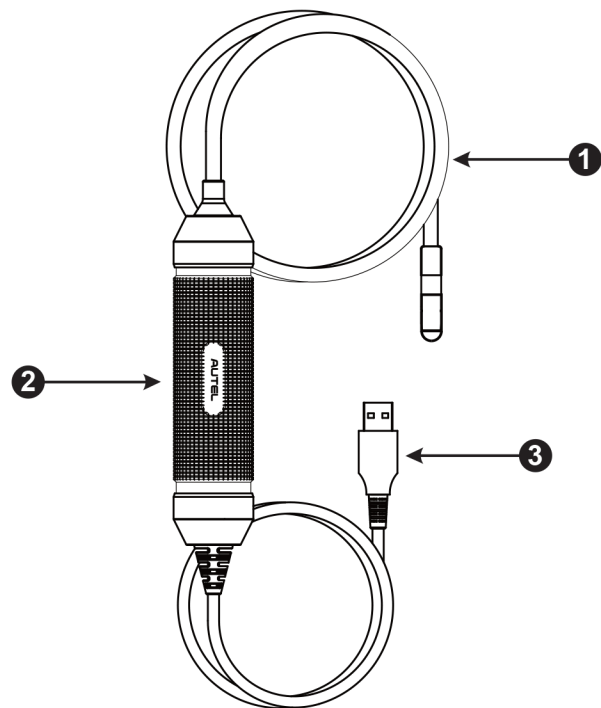

TECHNICAL SPECIFICATIONS

Item	Description
Imager Head Distance	MV108S: 8.5 mm; MV105S: 5.5 mm
Camera	MV108S: 2 MP; MV105S: 1 MP
Resolution	MV108S: 1920 x 1080 MV105S: 1280 x 720
Depth of Field	MV108S: 3 cm to 8 cm (1.18" to 3.15") MV105S: 2 cm to 10 cm (0.79" to 3.94")
LED Beads	8 pcs
Imager Head Cable Length	1 m (39.37")
Waterproof Level (Imager Head)	IP67
Operating Temp.	-10 °C to 70 °C (14 °F to 158 °F)
Storage Temp.	-10 °C to 70 °C (14 °F to 158 °F)

IT ONLY TAKES 3 STEPS TO START!

- 1 Insert the USB cable into the USB port on the tablet.

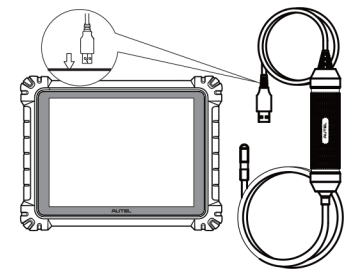

- 2 Remove the protective cover from the imager head.

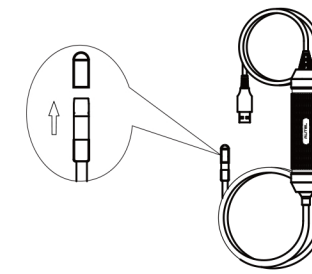

- 3 Power up your Autel tablet. Select the **MaxiVideo** application from the Job Menu. You can use it now.

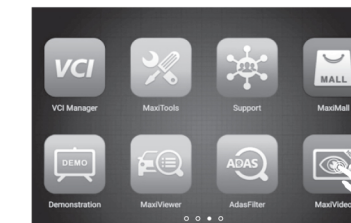

NOTE:

Not all Autel tablets have the MaxiVideo application installed. Please confirm whether your tablet supports this function before use. The tablet in the picture is for illustration only. Different tablet models may have different appearance and screens.

Imager Head Accessories

The MaxiVideo Inspection Camera kit is supplied with useful accessories, such as magnet, hook, and mirror, which enable you to perform special tasks.

8.5 mm Imager Head Accessories

1. Mirror — helps to look around corners and see the unreachable areas.
2. Hook — unclogs obstacles and picks up wires in the pipes or confined areas.
3. Magnet — picks up small iron objects, such as dropped rings or screws.

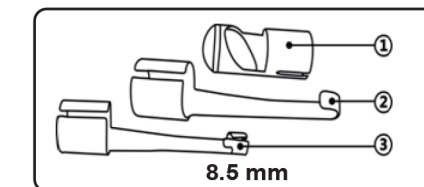

5.5 mm Imager Head Accessories

1. Mirror — helps to look around corners and see the unreachable areas.
2. Magnet — picks up small iron objects, such as dropped rings or screws.

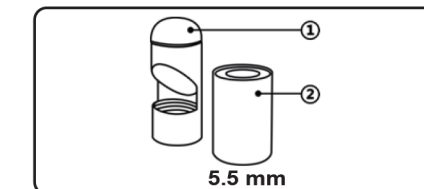

The accessory assembly is as simple as the picture shows!

For MV108S (with 8.5 mm imager head)

The three accessories, including the magnet, hook, and mirror, can be attached to the imager head as described. Hold the accessory and the imager head. Slip the end of the accessory over the imager head and then fix it as shown.

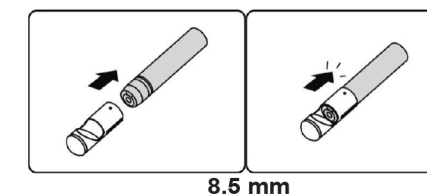

For MV105S (with 5.5 mm imager head)

The two accessories, both the magnet and mirror, can be attached to the imager head as described. Remove the sleeve tube from the imager head. Hold the accessory and the imager head as shown. Screw the thread part of the accessory over the imager head and then fix it.

